

Bulkhead coupler



BSPP female thread

G 1/4

Profile

British

Flow rate at 6 bar

750 l/min (?P : 0,6 bar)

Construction

Composite body

Drill Ø (mm)

27

Technology

"One push" safety system (avoids hose whip)

ID Passage

6 mm

Highlight

Anti-static Non scratch

Panel thickness (mm)

2 to 11

Operating pressure

2 to 12 bar

Temperature

-15°C to +70°C

Description

Reference	BSPP female thread	Drill Ø (mm)	Panel thickness (mm)
BSI 062101	G 1/4	27	2 to 11

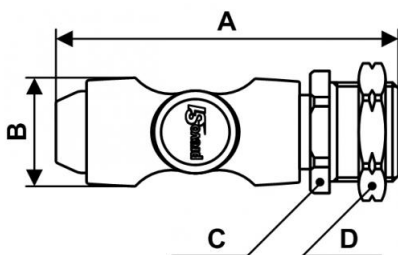

Dimensions

Reference	A mm	B mm	C mm	D mm
BSI 062101	84	30	29	32