

Parallel male thread coupler



BSP male thread

G 1/4

Profile

British

Technology

"One push" safety system (avoids hose whip)

Operating pressure

2 to 12 bar

Flow rate at 6 bar

750 l/min (?P : 0,6 bar)

ID Passage

6 mm

Temperature

-15°C to +70°C

Construction

Composite body

Highlight

Anti-static Non scratch

Description

Reference	BSP male thread
BSI 061151	G 1/4
BSI 061152	G 3/8
BSI 061153	G 1/2

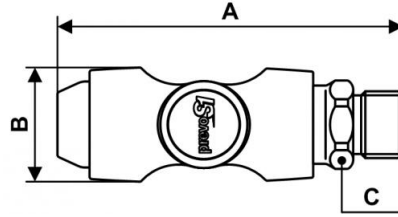

Dimensions

Reference	A mm	B mm	C mm
BSI 061151	83.9	30	20
BSI 061152	85.9	30	23
BSI 061153	89.9	30	26