

## Parallel male thread coupler



### BSPP male thread

G 1/4

### Technology

"One push" safety system  
(avoids hose whip)

### Operating pressure

2 to 12 bar

### Flow rate at 6 bar

833 l/min (?P = 0,6 bar)

### ID Passage

6 mm

### Temperature

-15°C to +70°C

### Construction

Composite body

### Highlight

Anti-static Non scratch

## Description

Reference	BSPP male thread
<b>ISI 061151</b>	G 1/4
<b>ISI 061152</b>	G 3/8
<b>ISI 061153</b>	G 1/2

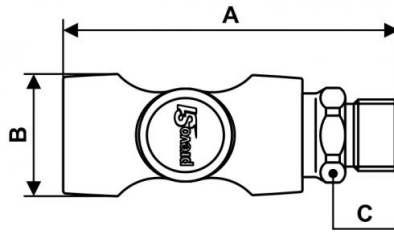

### Dimensions

Reference	A mm	B mm	C mm
<b>ISI 061151</b>	76.3	30	20
<b>ISI 061152</b>	78.3	30	23
<b>ISI 061153</b>	82.3	30	26