

Parallel male three-port manifold - RPN MG



Metric male thread

M5

For tube OD (mm)

4

Operating pressure

0 to 10 bar

Temperature

0°C to + 60°C

Construction

Polymer and nickel-plated
brass

Description

Reference	Metric male thread	For tube OD (mm)
RPN MG04M5	M5	4
RPN MG05M5	M5	5
RPN MG06M5	M5	6

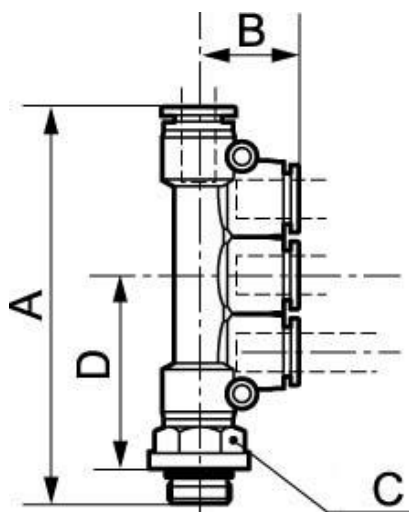

Dimensions				
Reference	A mm	B mm	C mm	D mm
RPN MG04M5	66.7	19.5	10	33.5
RPN MG05M5	66.7	19.5	10	31.5
RPN MG06M5	66.7	19.5	10	33.5