

Bidirectional regulator - Tube/Tube - RPO ET



For tube OD (mm)

4

Operating pressure

0 to 10 bar

Temperature

0°C to + 60°C

Construction

Polymer and nickel-plated brass

Description

Reference	For tube OD (mm)
RPO ET0404	4
RPO ET0606	6
RPO ET0808	8

Reference	For tube OD (mm)
RPO ET1010	10
RPO ET1212	12

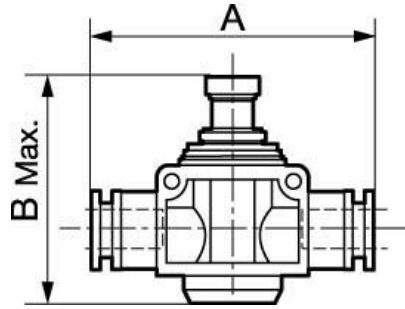

Dimensions		
Reference	A mm	B mm
RPO ET0404	48	31
RPO ET0606	49	46
RPO ET0808	55.1	50
RPO ET1010	63	53
RPO ET1212	75	63