

## Female thread single wall bracket - Outlet 1 coupler and drain



**Inlet BSPP female  
thread**

G 1/2

**Outlet BSPP female  
thread**

G 1/2

**Operating pressure**

0 to 16 bar

**Temperature**

-20°C to +80°C

**Construction**

Aluminium alloy

**Equipped with**

Manual drain

### Description

Reference	Inlet BSPP female thread	Outlet BSPP female thread
<b>MF 103S1</b>	G 1/2	G 1/2

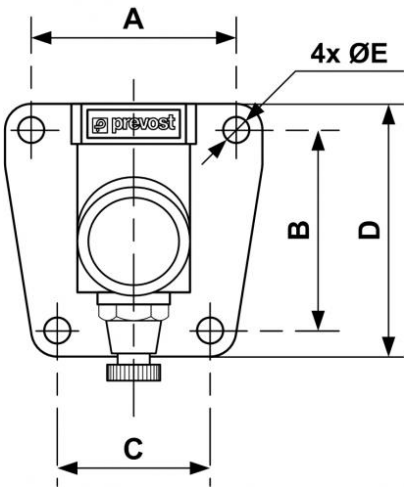

Dimensions					
Reference	A mm	B mm	C mm	D mm	E mm
MF 103S1	51	50	38	63	6.5