

Hydraulic coupler with flat ends



<p><u>BSPF female thread</u> G 1/4</p>	<p><u>Nominal Ø (mm)</u> 6</p>	<p><u>Flow rate (nominal in l/min)</u> 12</p>
<p><u>Max operating pressure (bar)</u> 300</p>	<p><u>Profile</u> ISO F</p>	<p><u>Technology</u> Ball lock</p>
<p><u>Temperature</u> -25°C to +100°C</p>	<p><u>Construction</u> Body: steel</p>	<p><u>Applications</u> Industry</p>
	<p><u>Connection</u> Automatic</p>	

Description				
Reference	BSPF female thread	Nominal Ø (mm)	Flow rate (nominal in l/min)	Max operating pressure (bar)

HFP 061101	G 1/4	6	12	300
HFP 131102	G 3/8	13	23	250
HFP 131103	G 1/2	13	23	250
HFP 201103	G 1/2	20	45	250
HFP 201104	G 3/4	20	45	250
HFP 251104	G 3/4	25	100	250
HFP 251105	G 1	25	100	250

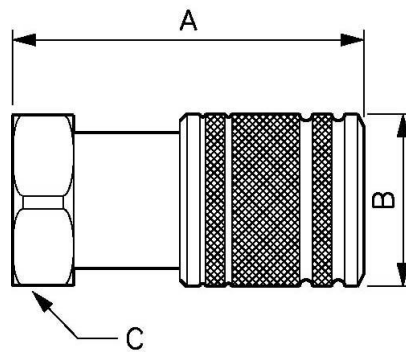

Dimensions			
Reference	A mm	B mm	C mm
HFP 061101	52.5	27	22
HFP 131102	66	30	27
HFP 131103	71.5	30	27

Reference	A mm	B mm	C mm
HFP 201103	78.5	38	32
HFP 201104	84	38	36
HFP 251104	86	48	46
HFP 251105	87.5	48	46