

Male thread valved adaptor



BSPP male thread

G 3/4

Operating pressure

0 to 10 bar

Flow rate

24 l/min (?P = 0,3 bar with shutter), 33,5 l/min (?P = 0,3 bar without shutter)

ID Passage

9 mm

Temperature

-15°C to +60°C

Construction

Chrome-plated brass body

Description

Reference

ELP 097154

BSPP male thread

G 3/4

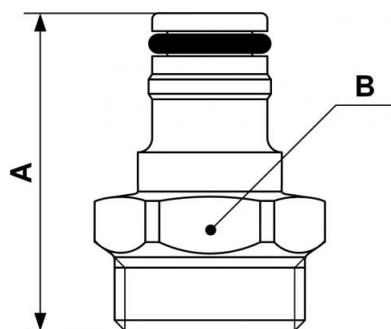

Dimensions		
Reference	A mm	B mm
ELP 097154	45	29