

ISO B hydraulic adaptor

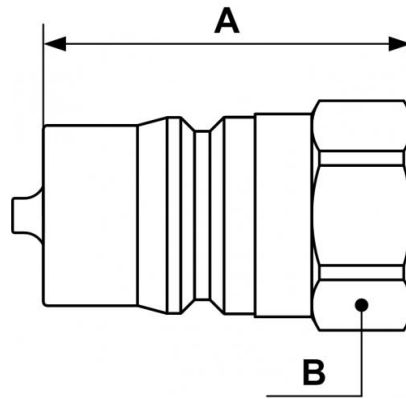

| | | | |
|---|--|--|---|
| <u>BSPP female thread</u> G 3/8 | <u>Nominal Ø (mm)</u> 10 | <u>Flow rate (nominal in l/min)</u> 23 | <u>Max operating pressure (bar)</u> 250 |
| <u>Profile</u> ISO B | <u>Technology</u> Ball lock | <u>Temperature</u> -25°C to +100°C | <u>Construction</u> Body: steel |
| <u>Applications</u> Industry | <u>Connection</u> Semi-automatic | | |

| Description | | | | |
|--------------------|--------------------|----------------|------------------------------|------------------------------|
| Reference | BSPP female thread | Nominal Ø (mm) | Flow rate (nominal in l/min) | Max operating pressure (bar) |
| HCIB 106102 | G 3/8 | 10 | 23 | 250 |
| HCIB 066101 | G 1/4 | 6 | 12 | 250 |
| HCIB 136103 | G 1/2 | 13 | 45 | 250 |
| HCIB 206104 | G 3/4 | 20 | 106 | 250 |
| HCIB 256105 | G 1 | 25 | 189 | 250 |



Dimensions

| Reference | A mm | B mm |
|--------------------|------|------|
| HCIB 106102 | 42.5 | 22 |
| HCIB 066101 | 38 | 19 |
| HCIB 136103 | 48 | 27 |
| HCIB 206104 | 57 | 34 |
| HCIB 256105 | 65.5 | 41 |